

**qi**

5V - 1000 mA

5V - 2400 mA

WPC QI - EN 62479 - ICNIRP

The diagram illustrates the Qi wireless charging standard. It shows a smartphone on a charging stand with two power output options: 5V - 1000 mA and 5V - 2400 mA. To the right, a visual equation shows a red cube representing the total unit, which is composed of a ring component and a phone component. Below this, four alternative components are shown with red X's over them, indicating they are not compatible with the Qi standard.

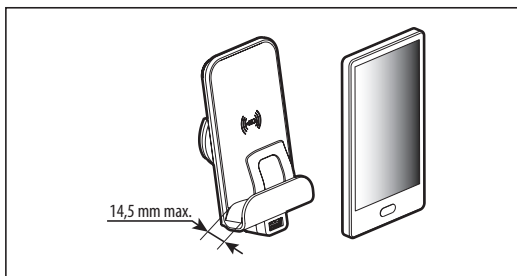
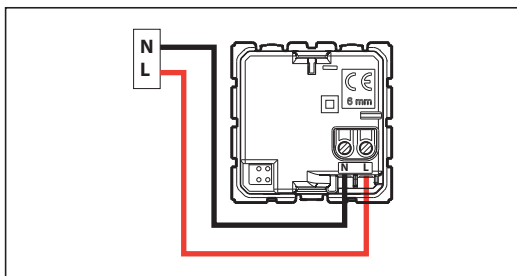

**1**

0674 62

0671 06

TOP

CLICK

CLICK

1

2

3

4

The diagram shows the assembly steps for the wireless charger. Step 1: Insert the internal component (0674 62) into the back cover (0671 06). Step 2: Insert the ring component into the internal component. Step 3: Insert the front cover. Step 4: Insert the smartphone. The diagram includes arrows and 'CLICK' labels to indicate the correct placement and orientation of the components. A 'TOP' label with an upward arrow indicates the orientation of the internal component.

