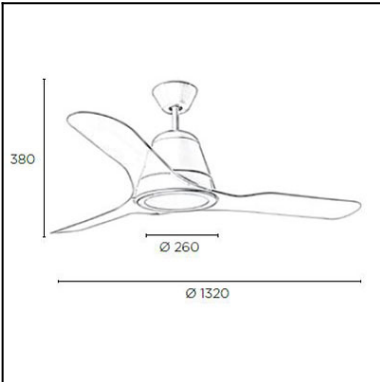
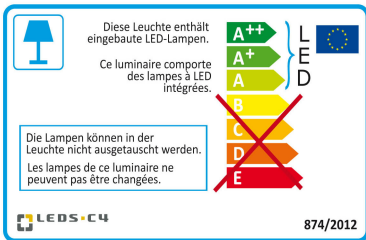

Design by Estudi Ribaudí

La finition de la photographie peut ne pas coïncider avec celle de la référence. Pour identifier la finition réelle, voir la description de cette dernière.

CARACTÉRISTIQUES TECHNIQUES

Type:	Ventilateur
RPM:	80/145/195
Indice de protection IP:	IP20
Source lumineuse 1:	91 x LED Refond 16,6W Blanc chaud - 3 000 K 1800 lm ^(N) CRI 80
Consommation totale (W):	76
Tension / Fréquence:	230V/50Hz
Garantie (Années):	2
Possibilité d'extension de garantie (Années):	5
Unités par caisse:	1
Poids net (kg):	7.845
EAN:	8435381412524

[Download photometric file .ldt / .ies](#)

Cliquez sur l'image pour télécharger l'étiquette-énergie

MATIÈRES / FINITIONS

Matière structure:	Acier Aluminium	Matière diffuseur:	Plastique
Finition structure:	Blanc brillant	Finition diffuseur:	Blanc Nuancé
Matière pale:	Acrylique		
Finitions pale:	Transparent		

ÉQUIPEMENT

Équipement compris: électronique

Lm^(N): Flux nominal du luminaire dans des conditions réelles de fonctionnement. Son flux réel dépend des conditions environnementales ainsi que de l'efficacité de la lentille et/ou du diffuseur.

LEDS-C4 se réserve le droit d'apporter les modifications techniques opportunes en vue d'améliorer les prestations du produit. Veuillez consulter l'équipe commerciale pour tout renseignement.

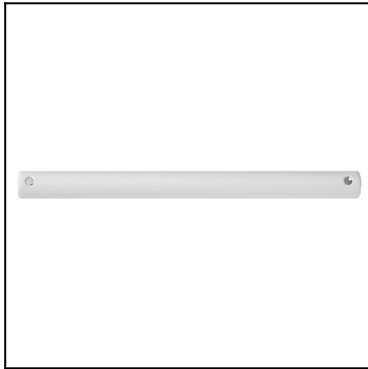
71-1844-CF-CF

Barre, 460 mm., Blanc brillant

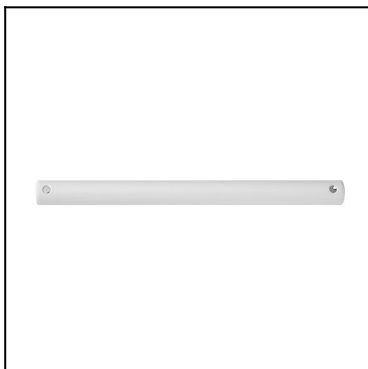
Matière structure: Acier
Finition structure: Blanc brillant

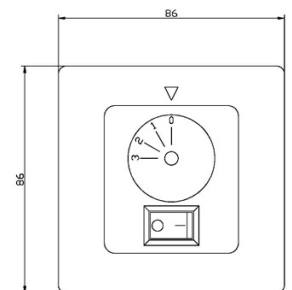

71-1843-CF-CF

Barre, 304 mm., Blanc brillant

Matière structure: Acier
Finition structure: Blanc brillant

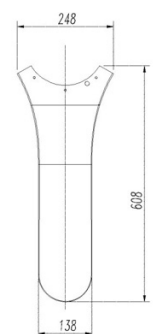

71-4932-00-00

Kit d'éclairage en option, Blanc brillant

71-4867-13-13

Matière structure: Acrylique
Finition structure: Magenta

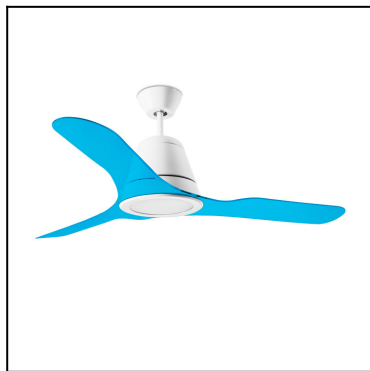

71-4867-11-11



Matière structure:
Finition structure:

Acrylique
Cyan

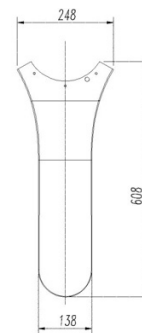

71-4867-24-24



Matière structure:
Finition structure:

Acrylique
Vert jaune

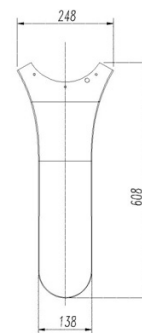

71-4867-CV-CV



Matière structure:
Finition structure:

Acrylique
Multicolore

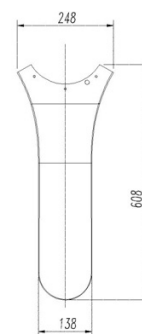

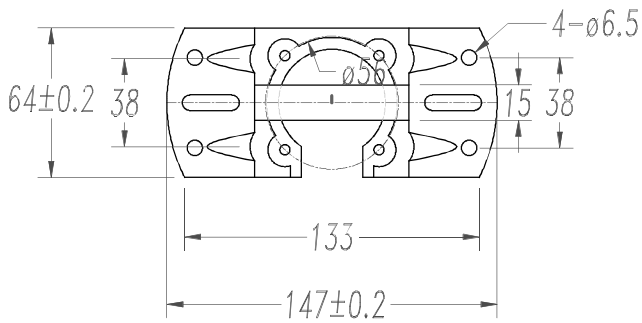
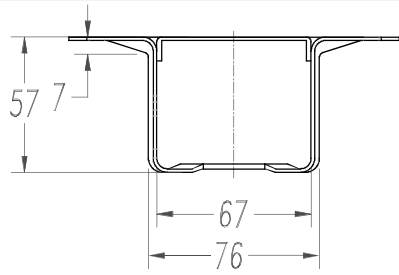

(2:1)

IRON / WHITE

IRON/WHITE

IRON/WHITE

ALUMINIUM / WHITE

FROSTED ACRYLIC DIFFUSER

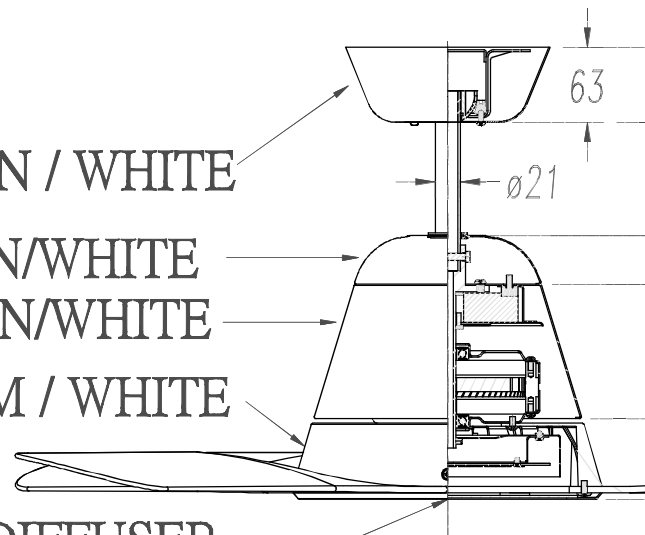

ACRYLIC TRANSPARENT BLADE

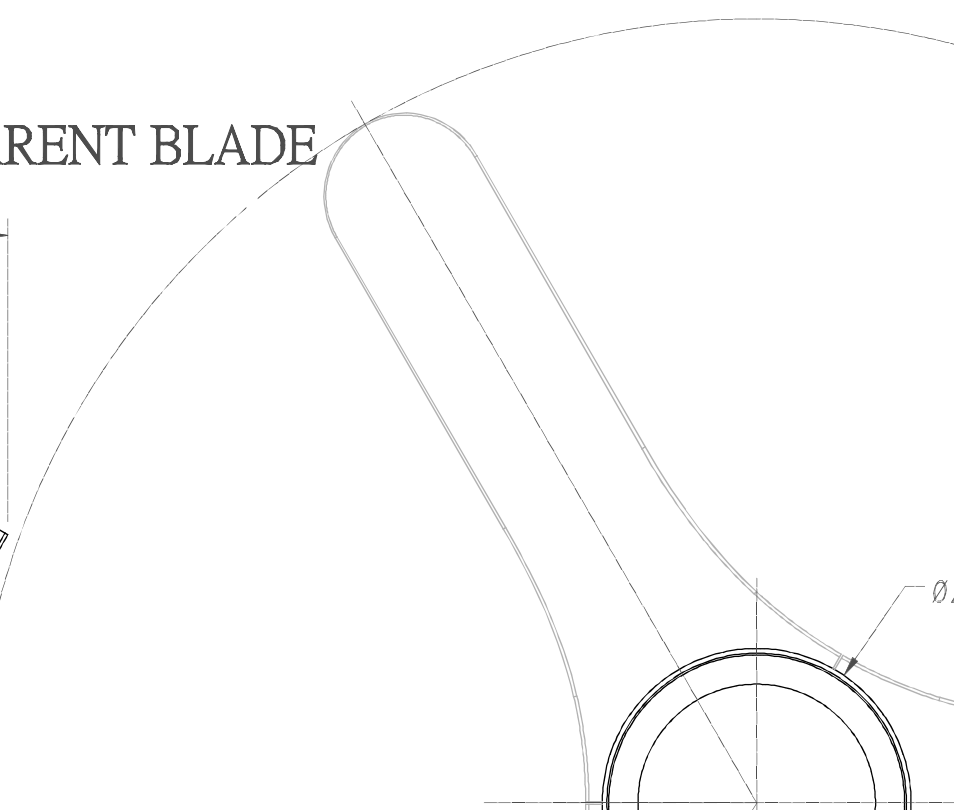
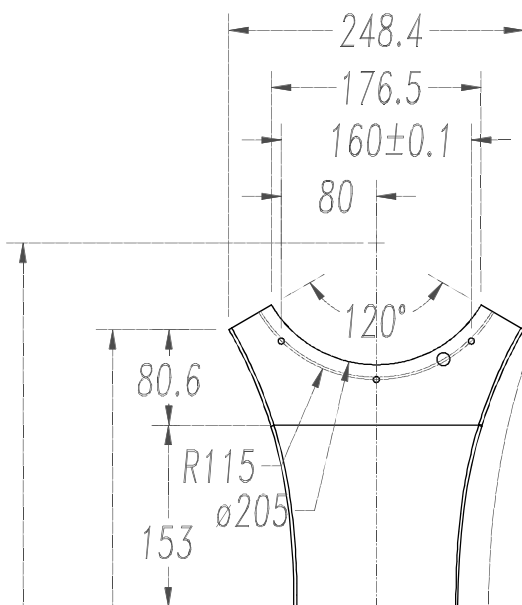



LED S-C4

30-3249-CF-M1

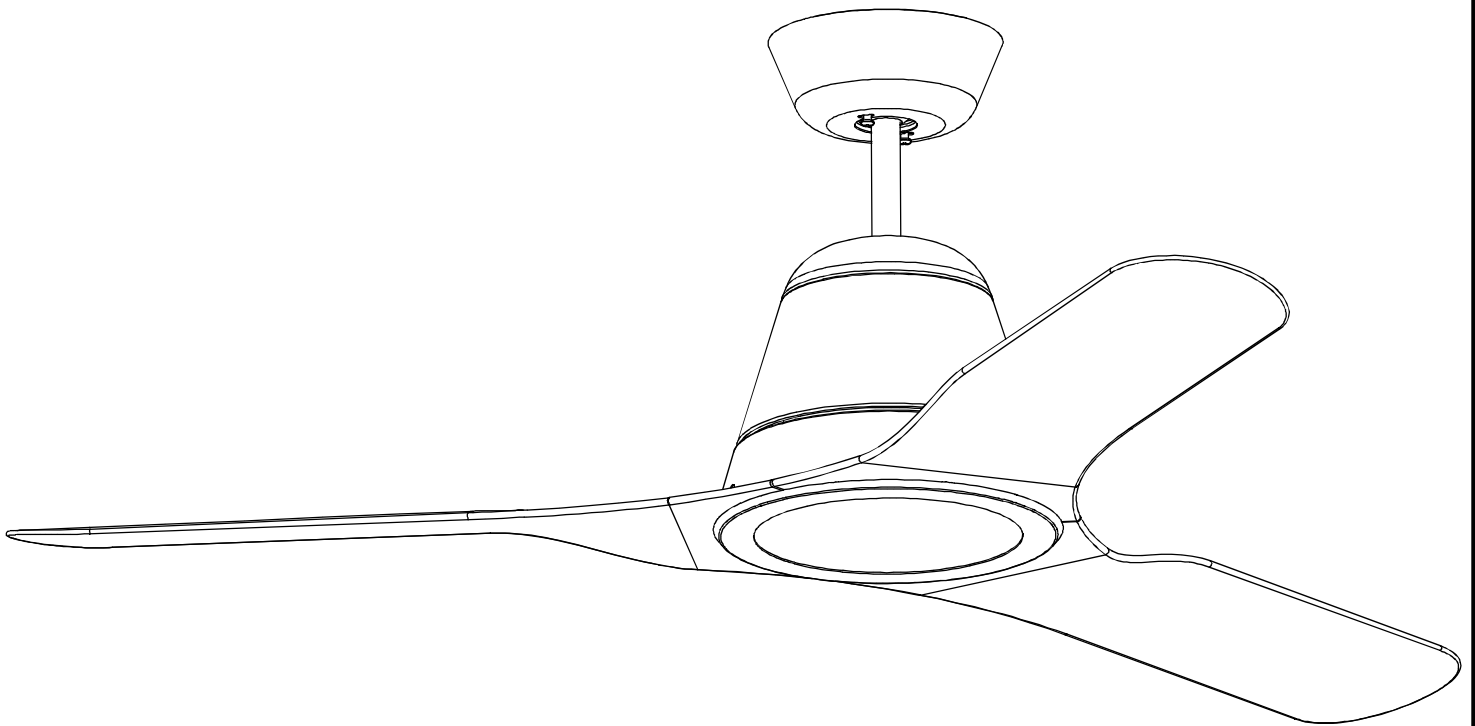



1

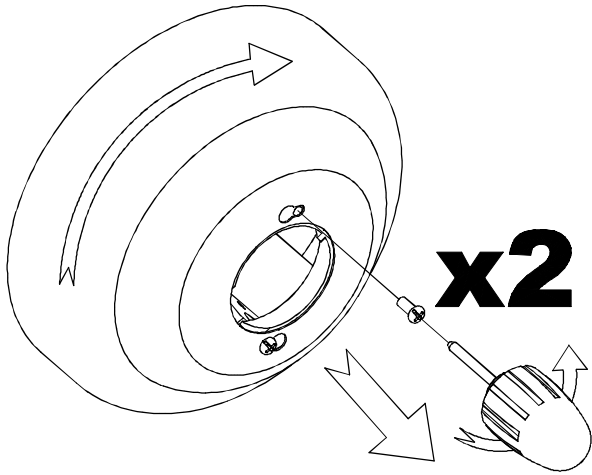

2

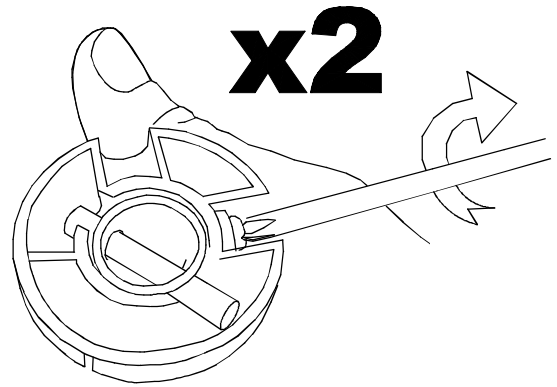

3

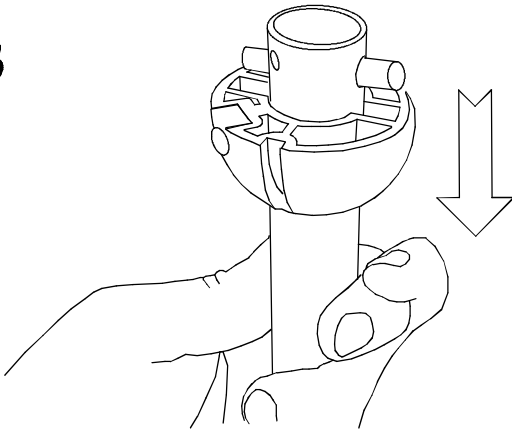

4

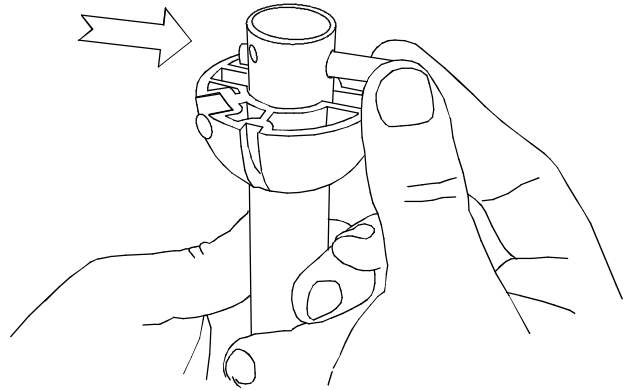

5

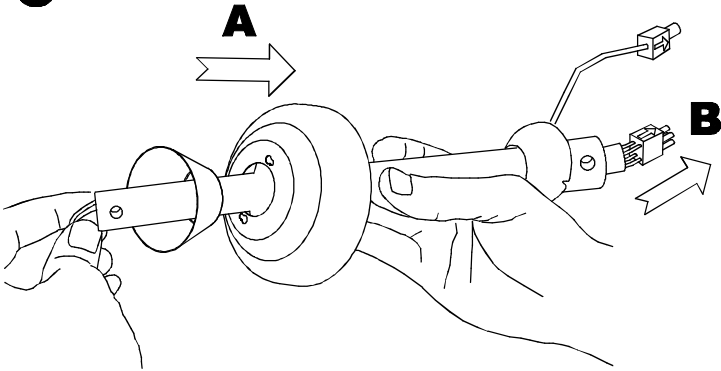

6

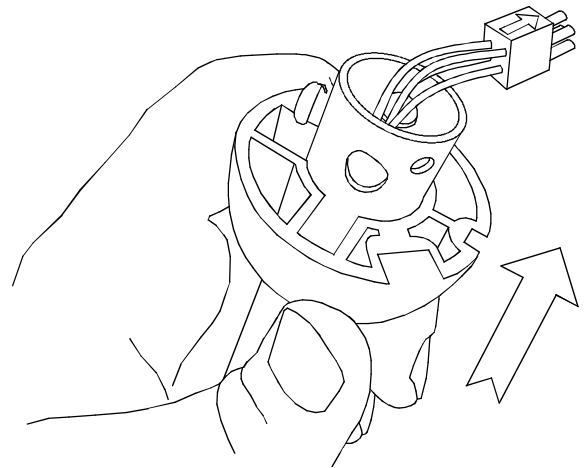

7

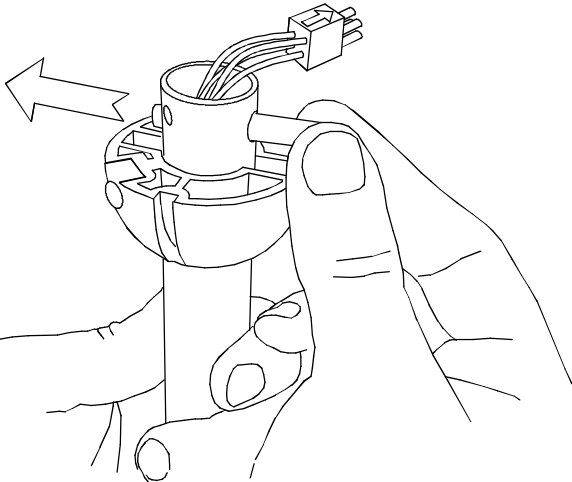

8

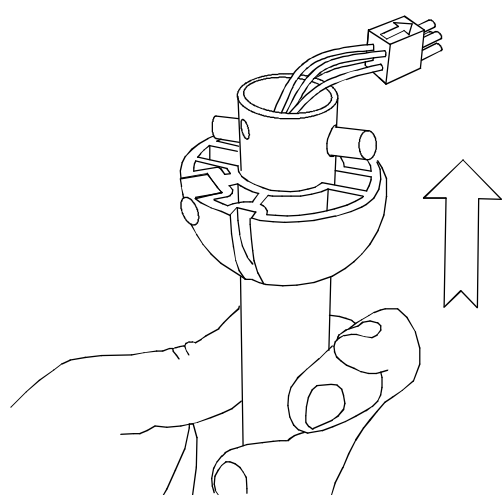



9

x2

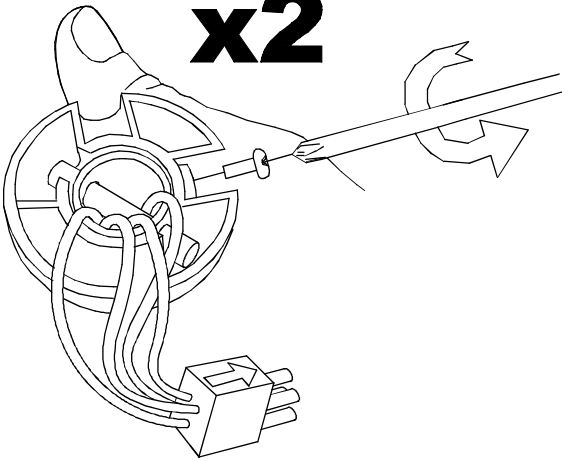

10

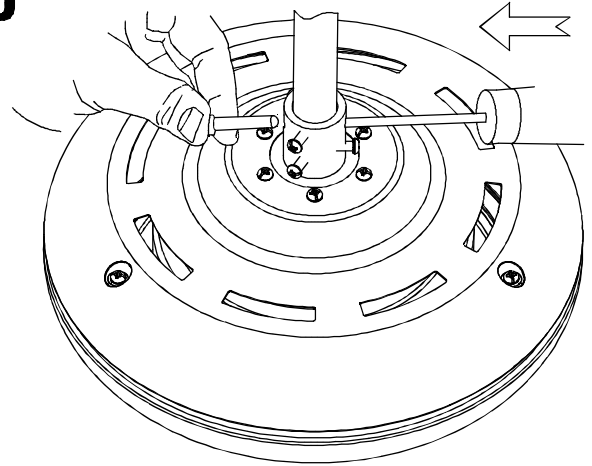

11

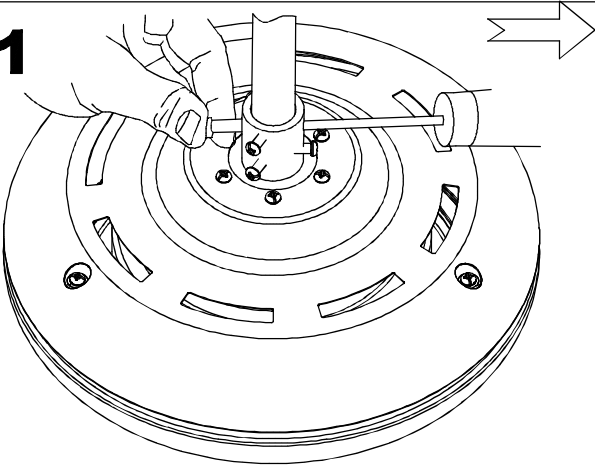

12

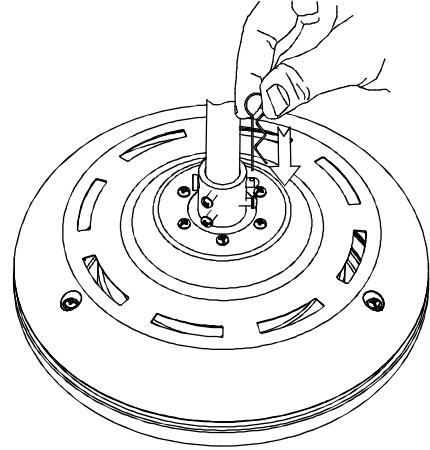

13

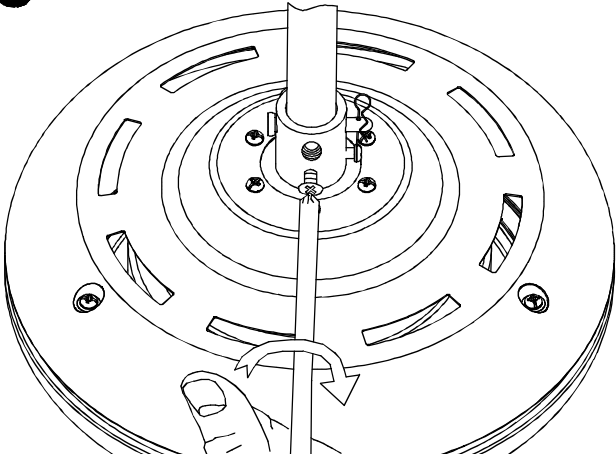

14

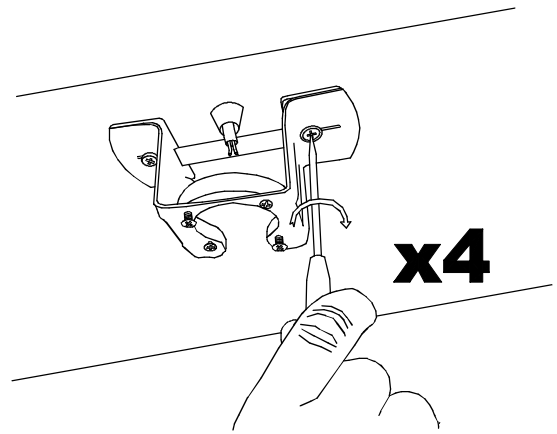

15

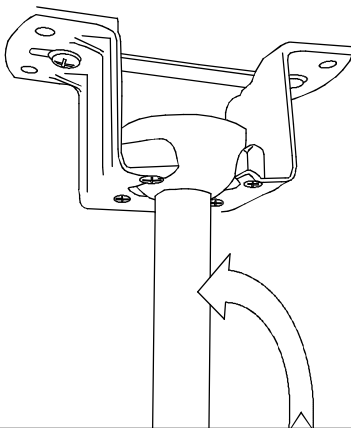

16

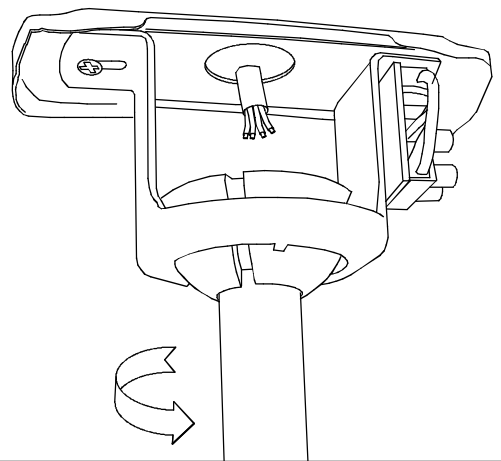

17

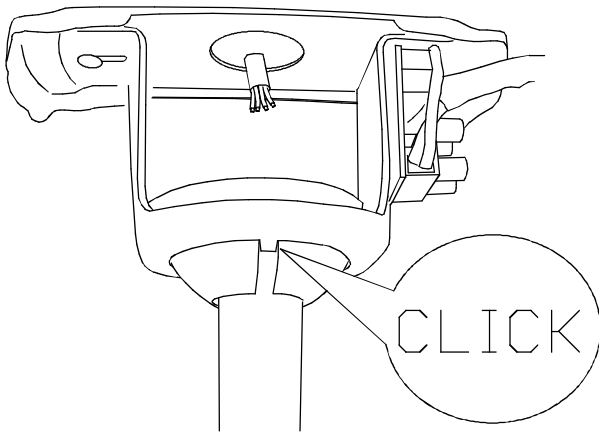

18

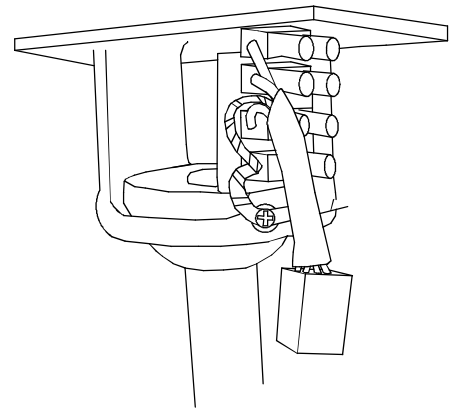

19

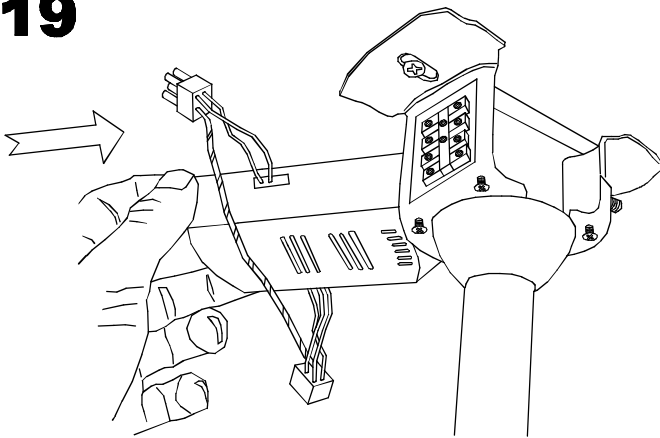

20

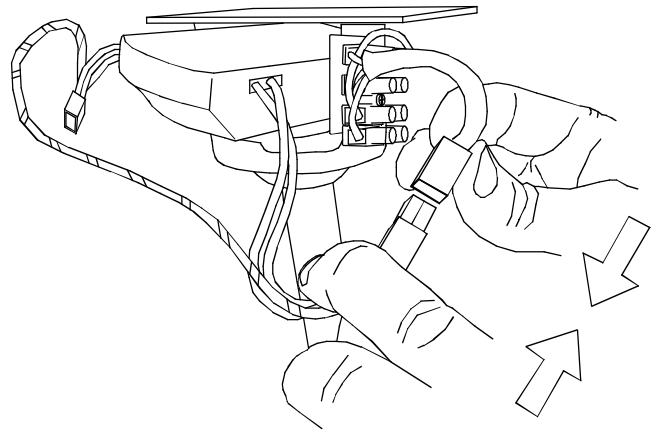

21

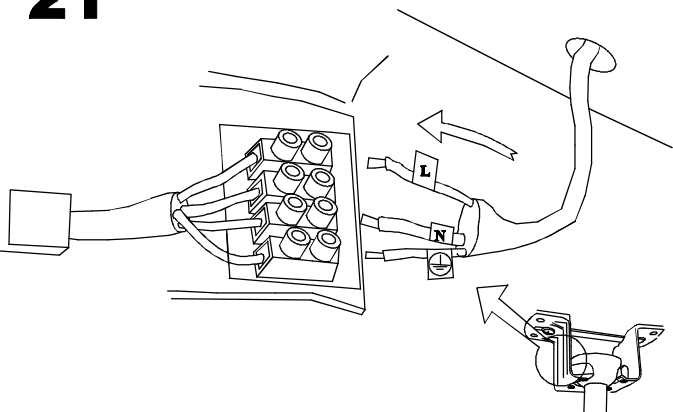

22

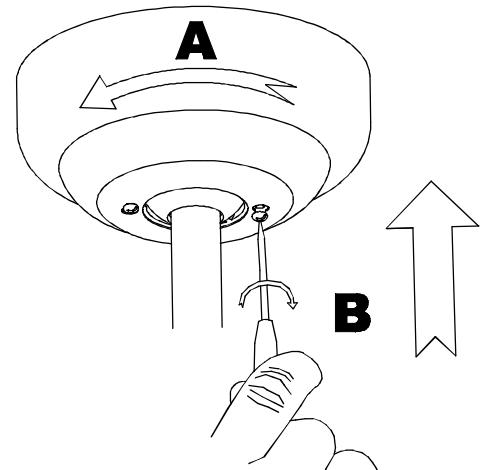

23

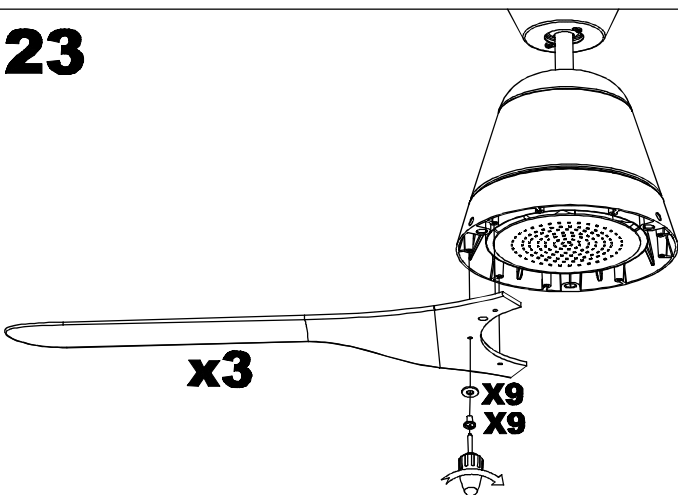

24

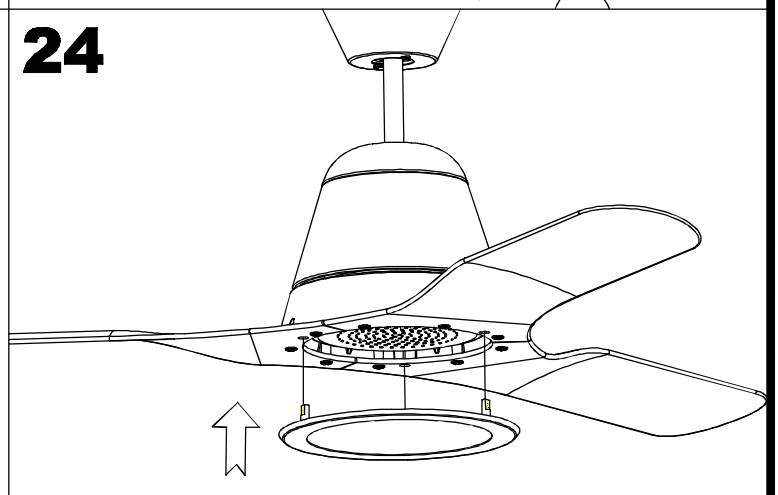



LEDS-C4

25

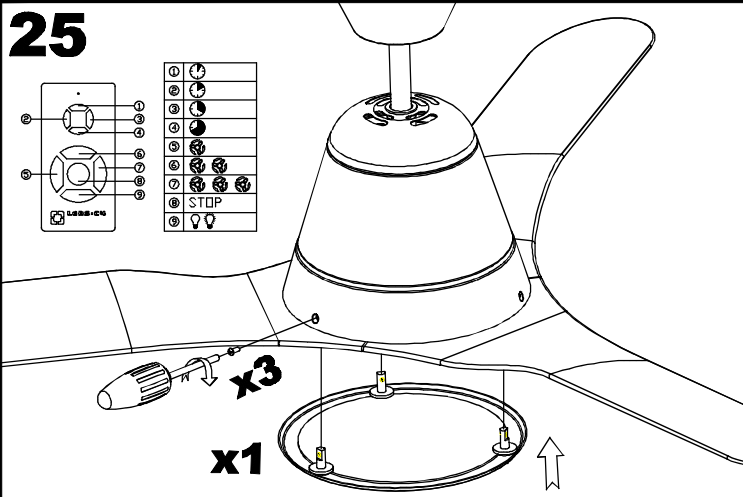

26

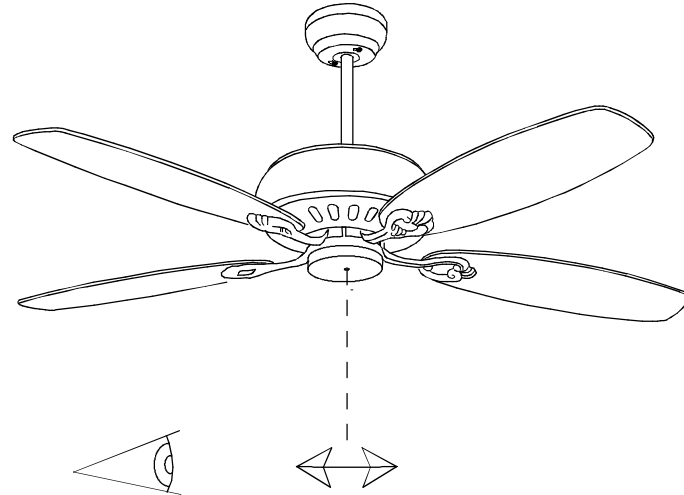
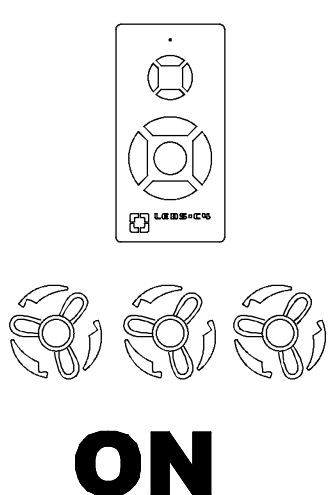
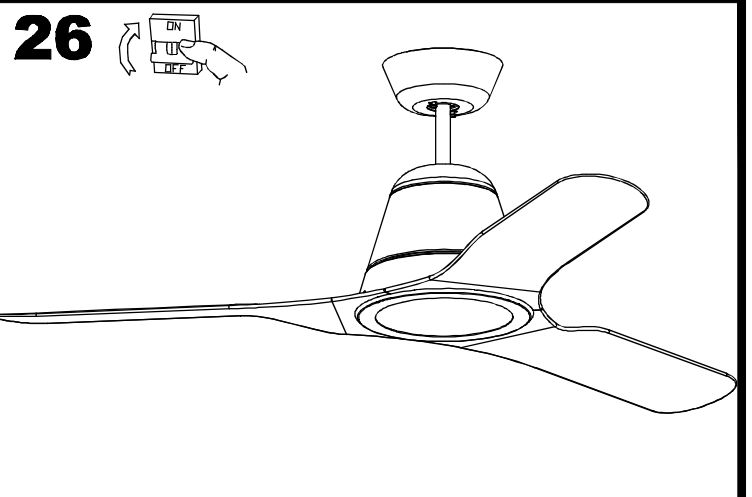

= OK

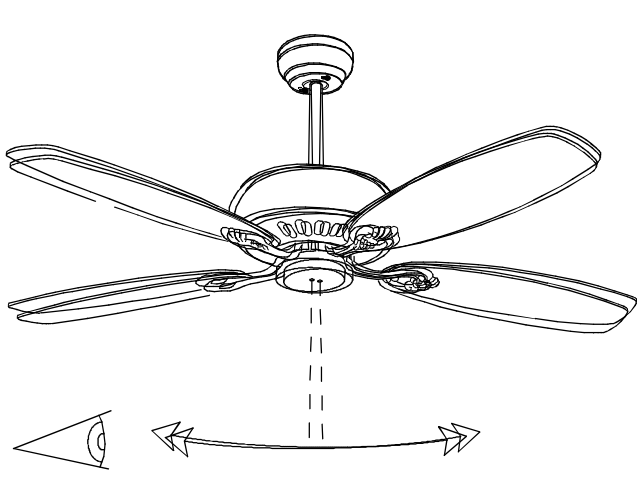
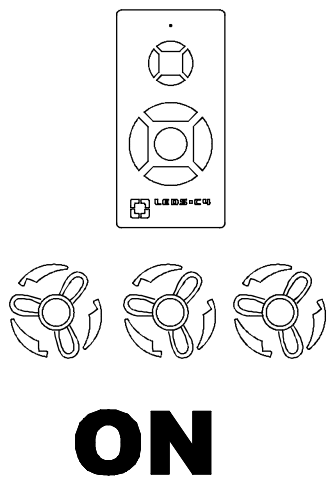

= NO

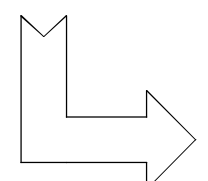

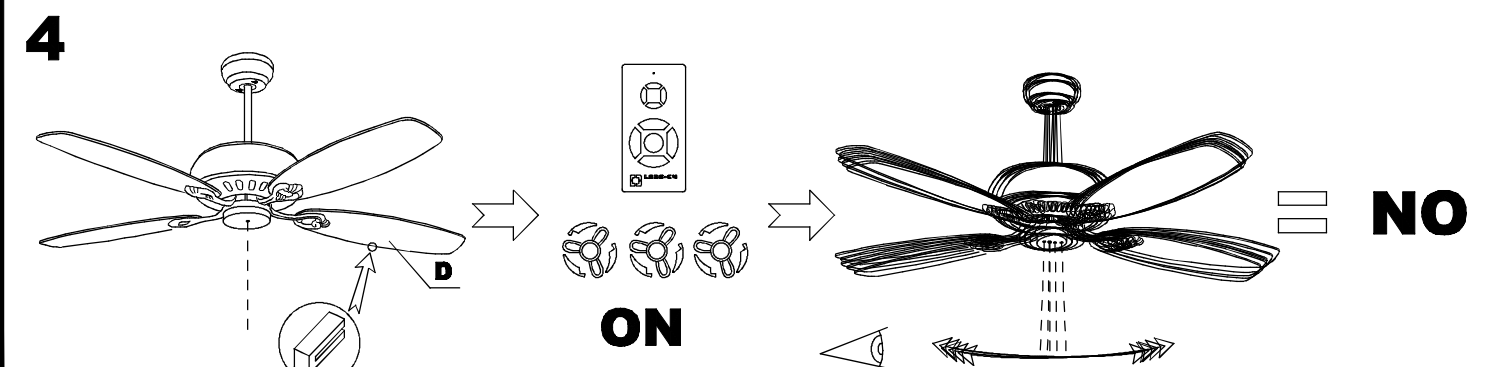
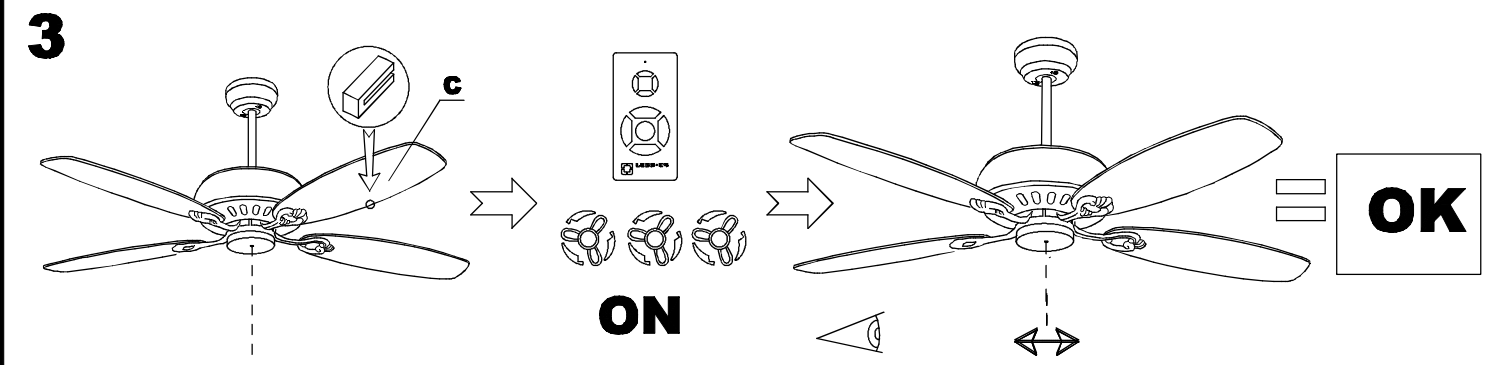
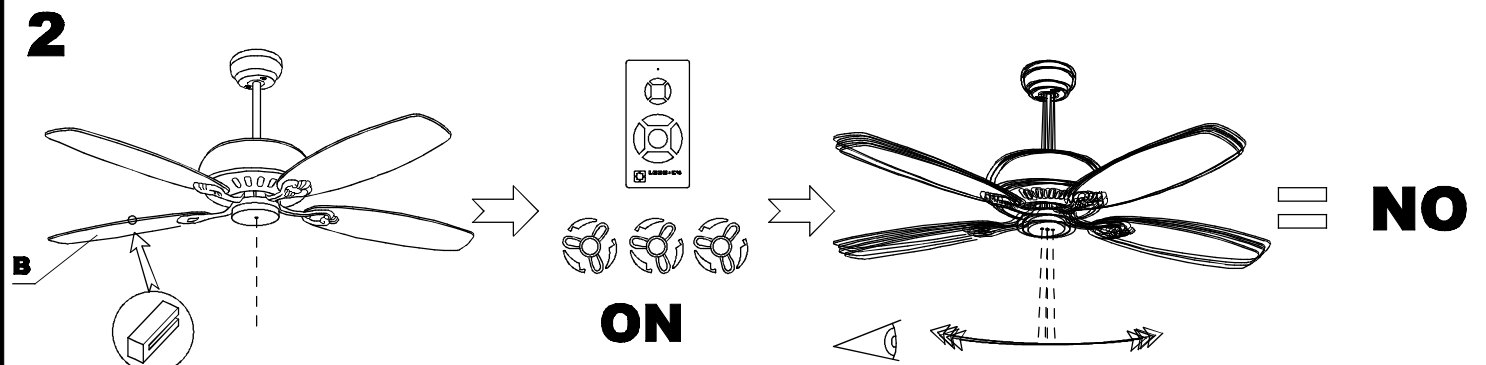
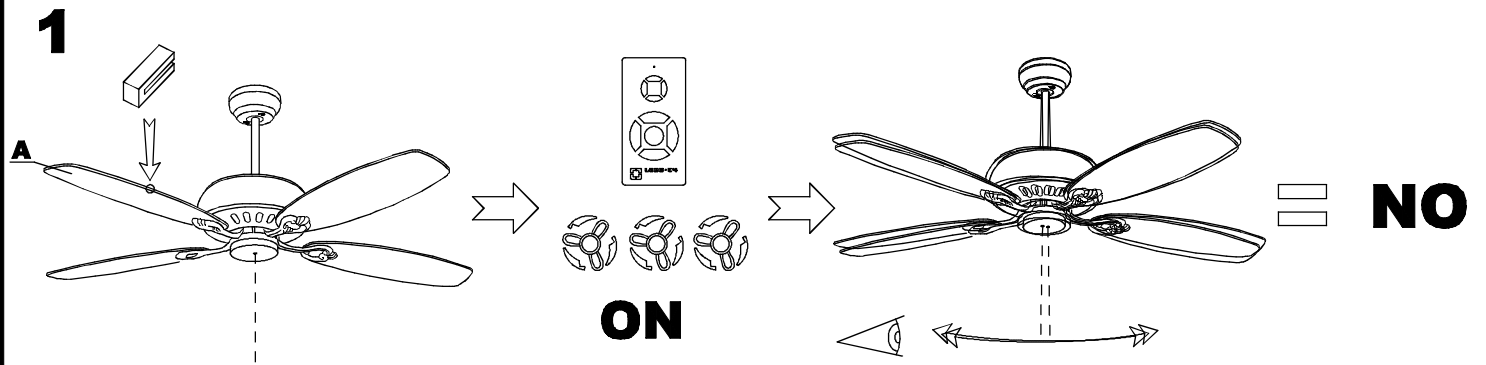
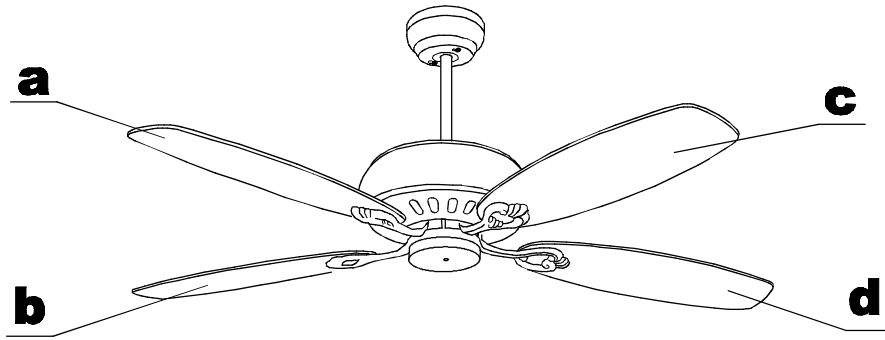

5

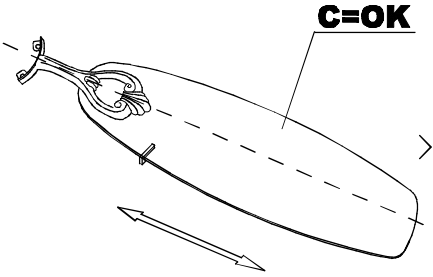

ON

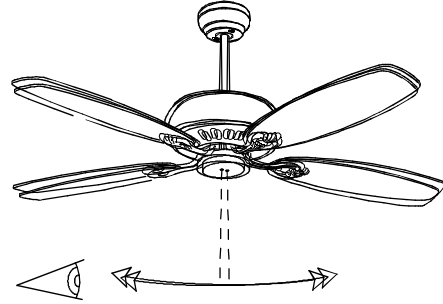

= NO

6

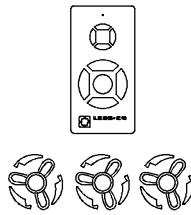
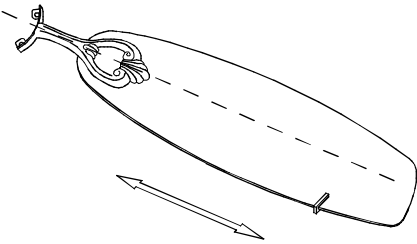

ON

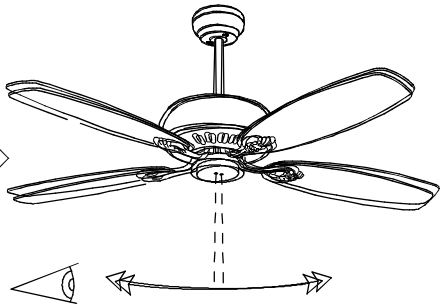

= NO

7

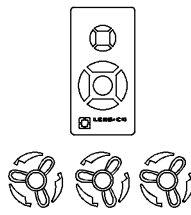
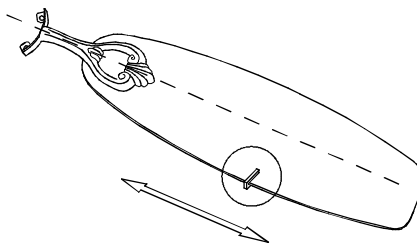

ON

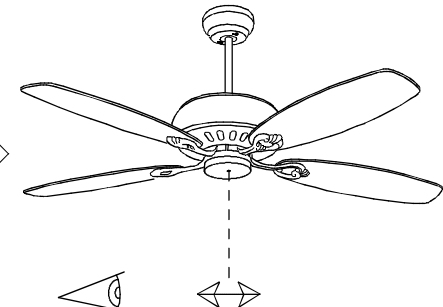

= OK

8

OK

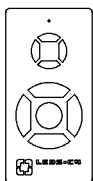
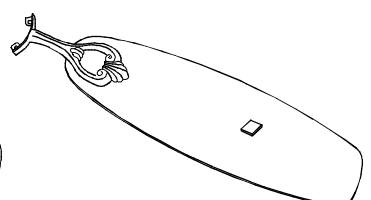
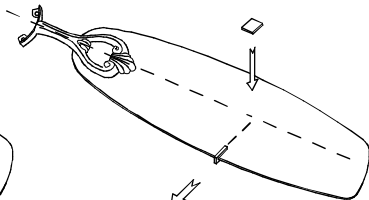
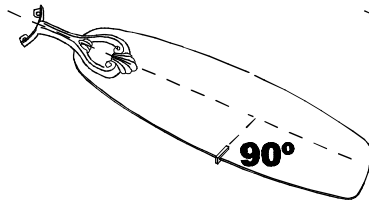
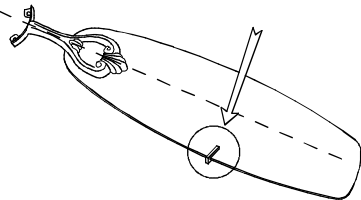

ON

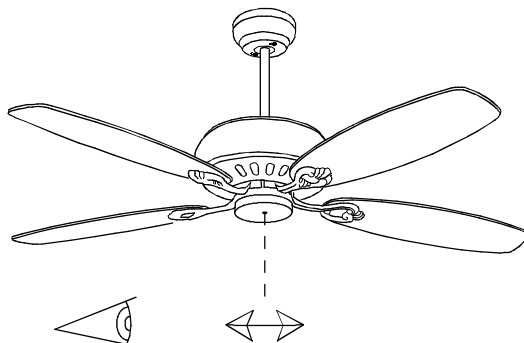

= OK